



# Parts Manual

Mfg. No: 12H802-1767-E1



---

| <b>Model Components</b>  | <b>Page</b> |
|--|-------------|
| Air Cleaner, Exhaust System.....   | 4           |
| Alternator, Electric Starter, Electrical, Flywheel, Flywheel Brake, Ignition, Rewind Starter.....      | 8           |
| Blower Housing/Shrouds.....  | 14          |
| Cams, Camshaft, Crankshaft, Cylinder, Engine Sump, Kit/Gaskets, Lubrication, Piston Group, Valves..... | 16          |
| Carburetor.....  | 26          |
| Controls, Fuel Supply, Governor Spring.....  | 30          |
| Replacement Engine - US & Canada.....  | 34          |

Not For  
Reproduction

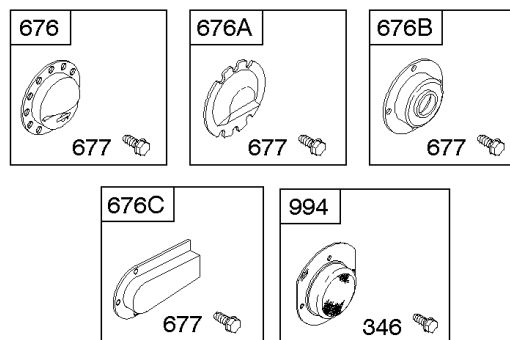
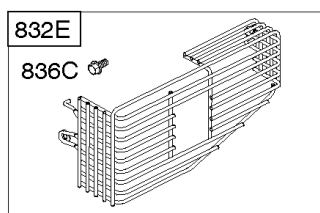
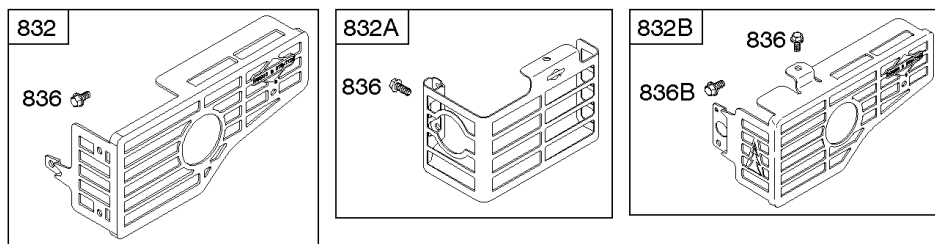
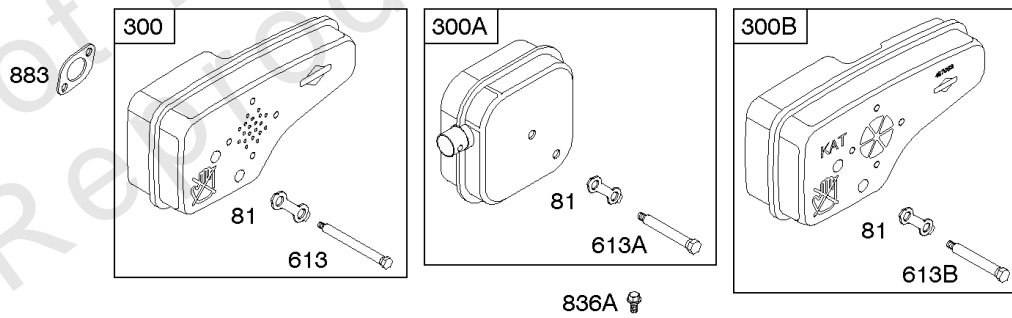
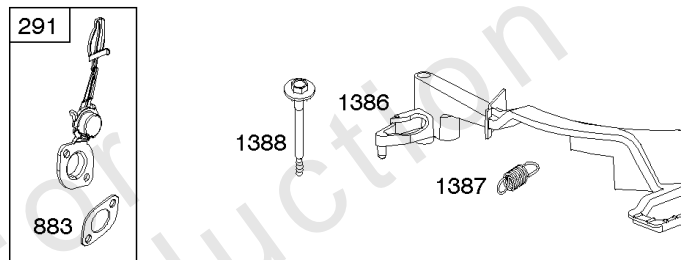
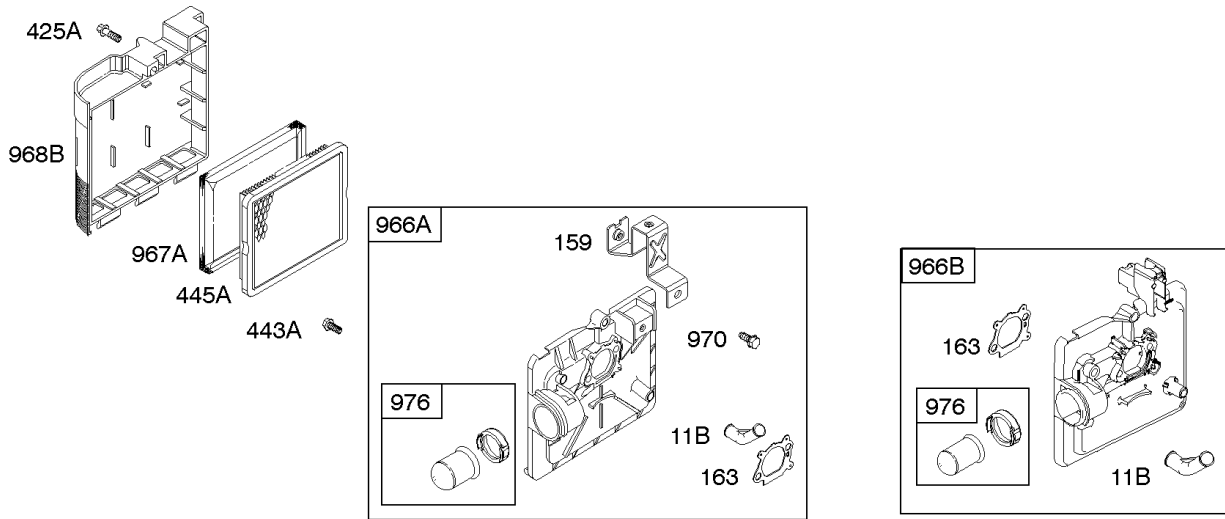

## Air Cleaner, Exhaust System

| REF NO | PART NO | QTY | DESCRIPTION                                       |
|--------|---------|-----|---|
| 11B    | 691923  |     | TUBE, Breather                                    |
| 81     | 691740  |     | LOCK, Muffler Screw                               |
| 159    | 691753  |     | BRACKET, Air Cleaner Primer                       |
| 163    | 272653S |     | GASKET, Air Cleaner<br>-(Air Cleaner)             |
| 291    | 790830  |     | THERMOSTAT  |
| 300    | 692038  |     | MUFFLER<br>-(Super Lo Tone)                       |
| 300A   | 494343S |     | MUFFLER<br>-(Square Lo Tone)                      |
| 300B   | 497681  |     | MUFFLER<br>-(Catalyst)                            |
| 346    | 690661  |     | SCREW<br>-(Spark Arrestor)                        |
| 425A   | 690670  |     | SCREW<br>-(Air Cleaner Cover)                     |
| 443A   | 692523  |     | SCREW<br>-(Air Cleaner Primer Base)               |
| 445A   | 491588S |     | FILTER, A/C Cartridge                             |
| 613    | 691340  |     | SCREW<br>-(Muffler)                               |
| 613A   | 691653  |     | SCREW<br>-(Muffler)                               |
| 613B   | 691114  |     | SCREW<br>-(Muffler)                               |
| 676    | 396548  |     | DEFLECTOR, Muffler<br>-(Louvered)                 |
| 676A   | 393756  |     | DEFLECTOR, Muffler<br>-(Side Outlet)              |
| 676B   | 397931  |     | DEFLECTOR, Muffler<br>-(Direct Out)               |
| 676C   | 493871  |     | DEFLECTOR, Muffler<br>-(Side Out)(Extended)       |
| 677    | 690661  |     | SCREW<br>-(Muffler Deflector)                     |
| 832    | 590486  |     | GUARD, Muffler<br>-Used After Code Date 11063000  |
| 832    | 499034  |     | GUARD, Muffler<br>-Used Before Code Date 11070100 |
| 832A   | 691424  |     | MUFFLER   |
| 832E   | 793568  |     | MUFFLER   |
| 832B   | 497683  |     | GUARD, Muffler                                    |
| 836    | 690664  |     | SCREW<br>-(Muffler Guard)                         |
| 836A   | 690661  |     | SCREW<br>-(Muffler Guard)                         |
| 836B   | 691147  |     | SCREW<br>-(Muffler Guard)                         |
| 836C   | 790745  |     | SCREW<br>-(Muffler Guard)                         |
| 883    | 691881  |     | GASKET, Exhaust                                   |
| 966A   | 496116  |     | BASE, Air Cleaner<br>-(Primer)                    |
| 966B   | 792040  |     | BASE, Air Cleaner<br>-(Primer)                    |
| 967A   | 493537S |     | FILTER, Air Cleaner Foam                          |
| 968B   | 692298  |     | COVER, Air Cleaner                                |
| 970    | 691669  |     | SCREW<br>-(Air Cleaner Primer Bracket)            |

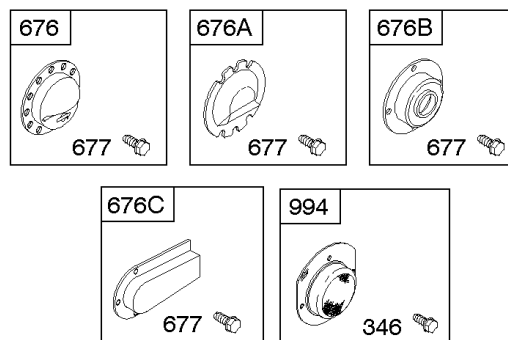
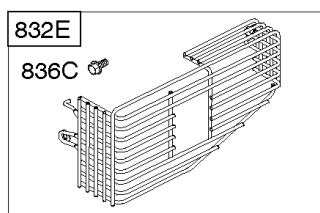
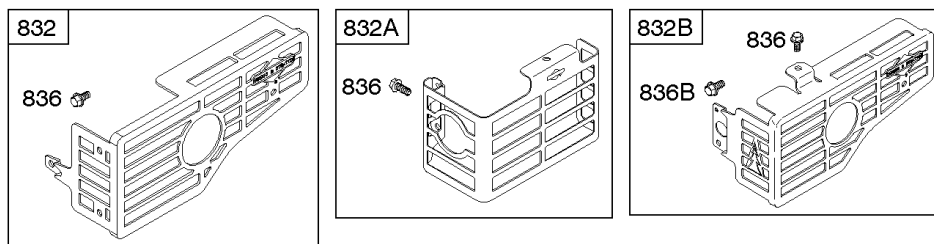
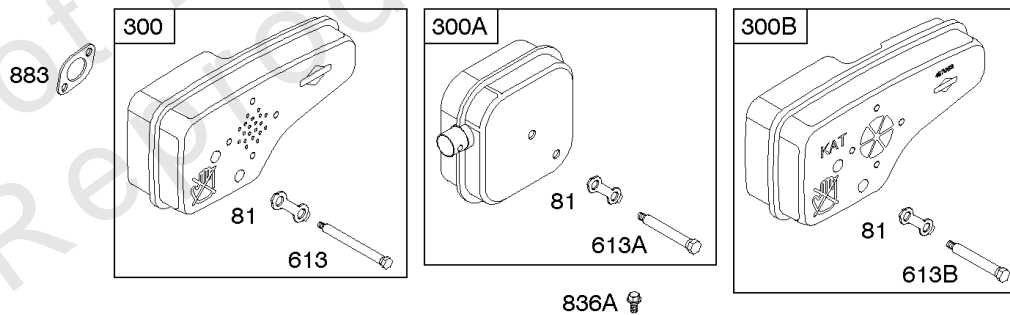
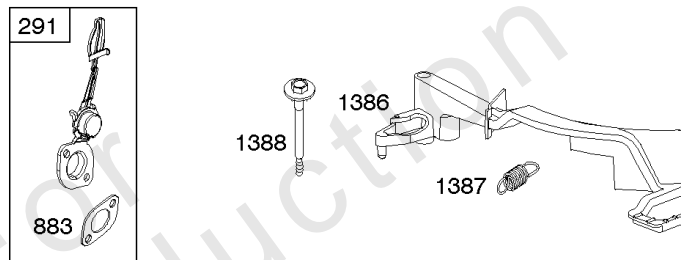
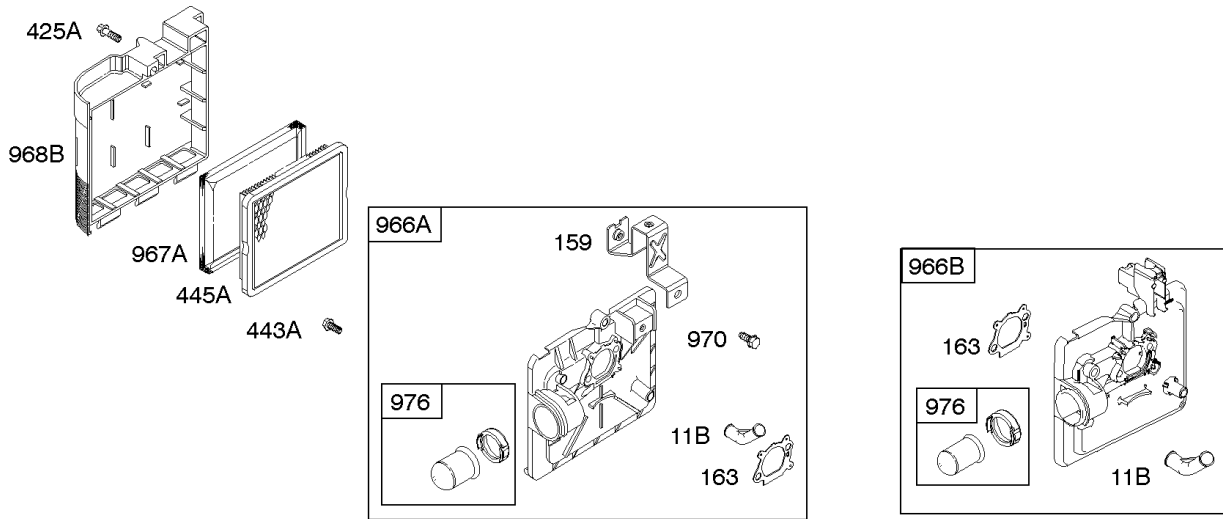

## *Air Cleaner, Exhaust System*

---

| REF NO | PART NO | QTY | DESCRIPTION                              |
|--------|---------|-----|--|
| 976    | 694395  |     | PRIMER, Carburetor                       |
| 994    | 398067  |     | ARRESTOR-SPARK                           |
| 1386   | 790848  |     | VANE, Air<br>-(Autochoke System)         |
| 1387   | 790849  |     | SPRING, Air Vane                         |
| 1388   | 790850  |     | SCREW<br>-(Air Vane) (Auto Choke System) |

Not For Reproduction

# Alternator, Electric Starter, Electrical, Flywheel, Flywheel Brake, Ignition, Rewind Starter

Mfg. No: 12H802-1767-E1

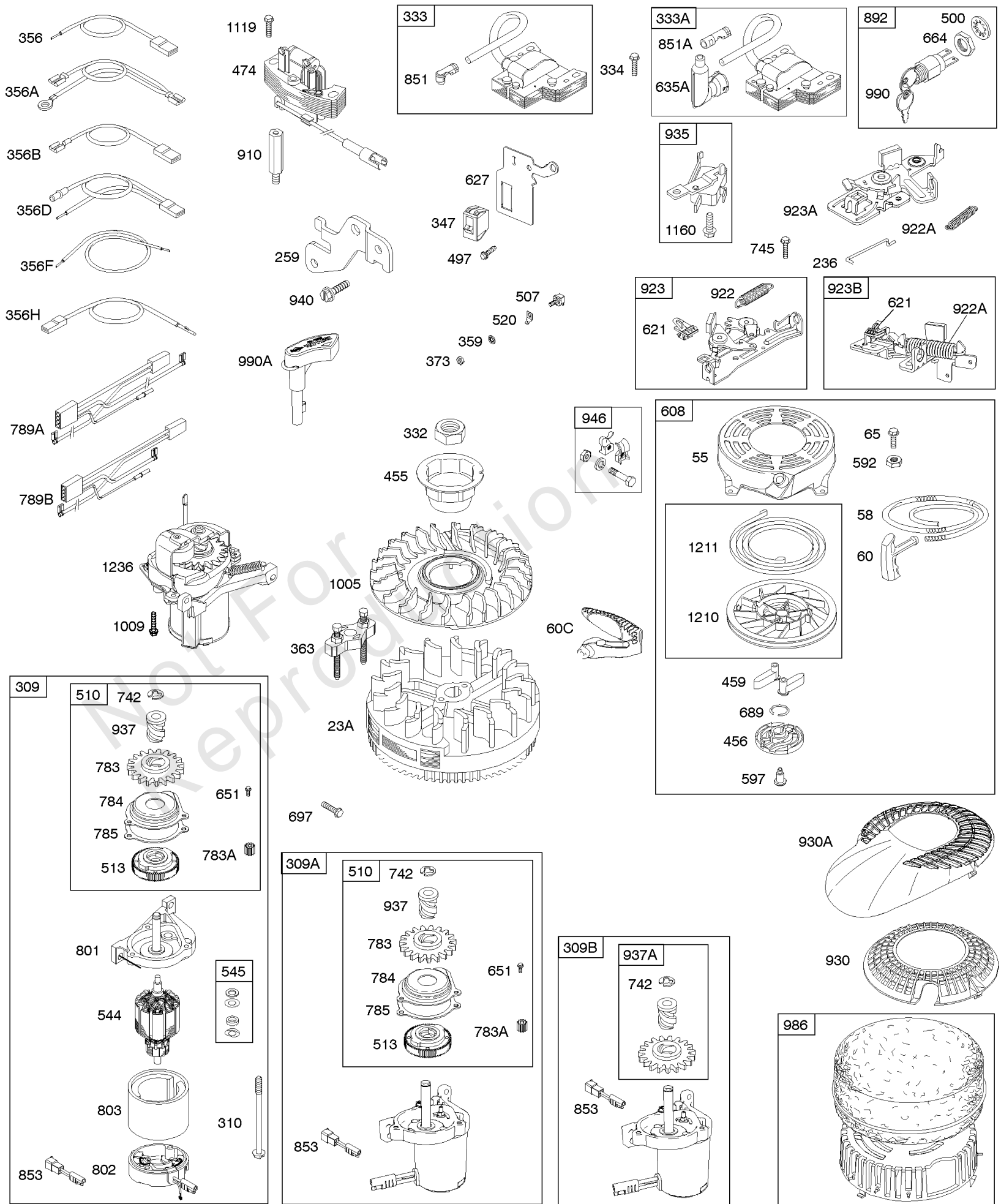



## Alternator, Electric Starter, Electrical, Flywheel, Flywheel Brake, Ignition, Rewind Starter

| REF NO | PART NO | QTY | DESCRIPTION   |
|--------|---------|-----|---|
| 23A    | 691987  |     | FLYWHEEL  |
| 55     | 691421  |     | HOUSING, Rewind Starter   |
| 58     | 280399S |     | ROPE-STARTER<br>-(Cut To Required Length)   |
| 60     | 281434S |     | GRIP, Starter Rope  |
| 60C    | 799716  |     | GRIP, Starter Rope  |
| 65     | 690837  |     | SCREW<br>-(Rewind Starter)  |
| 236    | 691826  |     | LINK, Lockout   |
| 259    | 691223  |     | BRACKET, Casing Clamp<br>-(Control Wire Casing)                                     |
| 309    | 695550  |     | MOTOR, Starter<br>-Used Before Code Date 07052900                                   |
| 309A   | 795092  |     | MOTOR, Starter<br>-Used After Code Date 07052800<br>-Used Before Code Date 10112800 |
| 309B   | 799045  |     | MOTOR-STARTER<br>-Used After Code Date 10112700                                     |
| 310    | 692327  |     | SCREW<br>-(Starter Motor)   |
| 332    | 690662  |     | NUT<br>-(Flywheel)  |
| 333    | 802574  |     | ARMATURE, Magneto   |
| 333A   | 793353  |     | ARMATURE, Magneto<br>-(Snap In Spark Plug Boot)                                     |
| 333A   | 792640  |     | ARMATURE, Magneto<br>-(Screw On Spark Plug Boot)                                    |
| 334    | 691061  |     | SCREW<br>-(Magneto Armature)  |
| 347    | 691396  |     | SWITCH, Rocker  |
| 356    | 692390  |     | WIRE, Stop  |
| 356A   | 690650  |     | WIRE, Stop  |
| 356D   | 496381  |     | WIRE, Stop  |
| 356F   | 494250  |     | WIRE, Stop  |
| 356H   | 690791  |     | WIRE, Stop  |
| 356B   | 693010  |     | WIRE, Stop  |
| 359    | 691077  |     | WASHER<br>-(Ground Terminal)  |
| 363    | 19069   |     | PULLER, Flywheel  |
| 373    | 691612  |     | NUT<br>-(Ground Terminal)   |
| 455    | 791960  |     | CUP, Flywheel   |
| 456    | 692299  |     | PLATE-PAWL FRICTION   |
| 459    | 281505S |     | PAWL-RATCHET  |
| 474    | 691991  |     | ALTERNATOR  |
| 497    | 690664  |     | SCREW<br>-(Muffler Guard) (Stopswitch Bracket)                                      |
| 500    | 691086  |     | WASHER<br>-(Key Switch)   |
| 507    | 691972  |     | INSULATOR   |
| 510    | 795093  |     | DRIVE, Starter  |
| 513    | 692358  |     | CLUTCH, Drive   |
| 520    | 691084  |     | TERMINAL, Ground  |
| 544    | 690786  |     | ARMATURE, Starter   |
| 545    | 492919  |     | WASHER<br>-(Starter Motor)  |

# Alternator, Electric Starter, Electrical, Flywheel, Flywheel Brake, Ignition, Rewind Starter

Mfg. No: 12H802-1767-E1

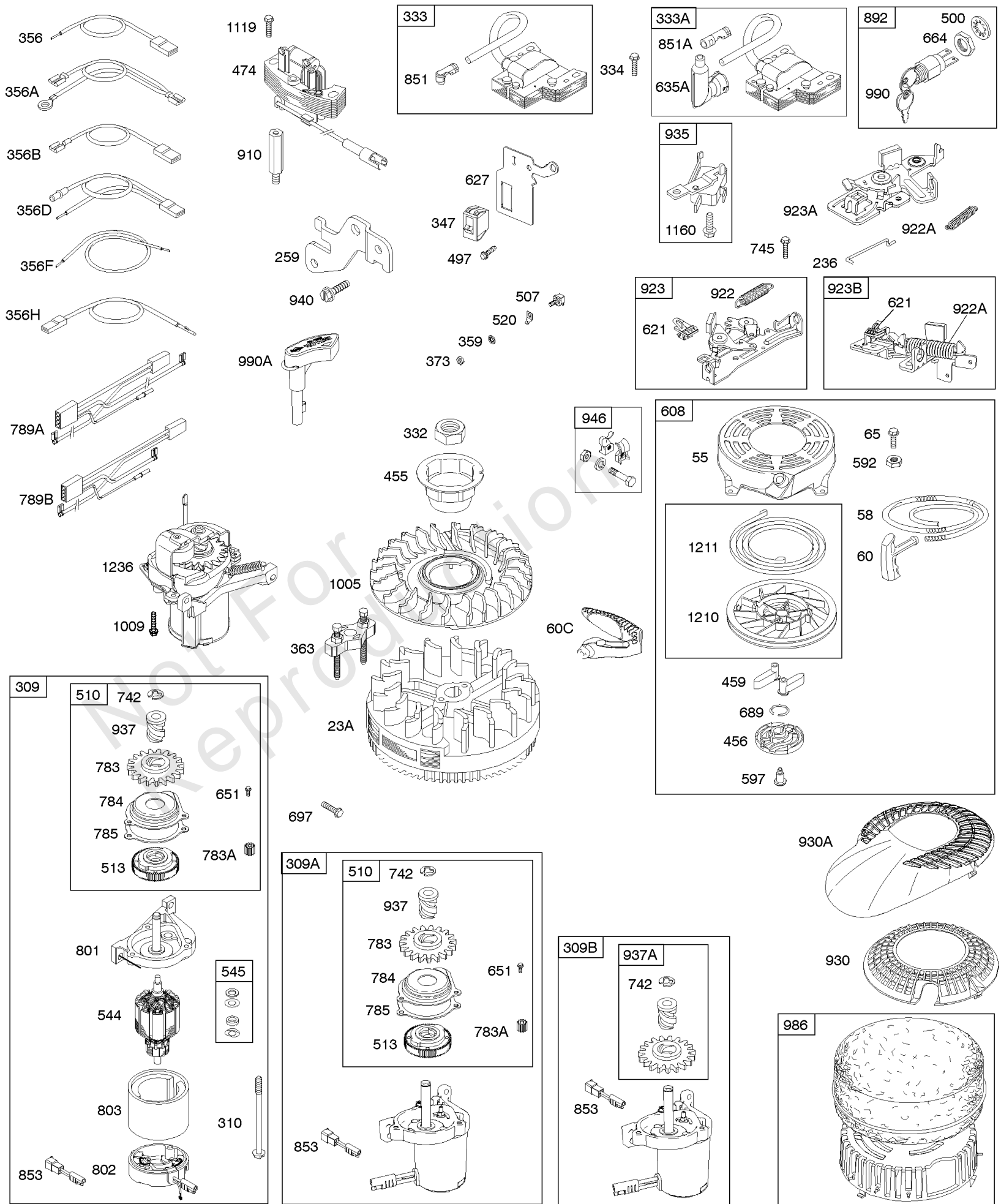

## *Alternator, Electric Starter, Electrical, Flywheel, Flywheel Brake, Ignition, Rewind Starter*

| REF NO | PART NO | QTY | DESCRIPTION  |
|--------|---------|-----|--|
| 592    | 690800  |     | NUT<br>-(Rewind Starter)                             |
| 597    | 691696  |     | SCREW<br>-(Pawl Friction Plate)                      |
| 608    | 497680  |     | STARTER, Rewind                                      |
| 621    | 692310  |     | SWITCH, Stop   |
| 627    | 692872  |     | BRACKET, Stopswitch                                  |
| 635A   | 792597  |     | BOOT, Spark Plug<br>-(Screw On Style)                |
| 635A   | 793351  |     | SHIELD-SPARK PLUG<br>-(Snap In Style)                |
| 651    | 691660  |     | SCREW<br>-(Starter Gear Cover)                       |
| 664    | 691087  |     | NUT<br>-(Key Switch)                                 |
| 689    | 691855  |     | SPRING-FRICTION                                      |
| 697    | 691127  |     | SCREW<br>-(Starter Motor) (Drive Cap)                |
| 742    | 93941   |     | RETAINER, E Ring                                     |
| 745    | 691648  |     | SCREW<br>-(Muffler Adapter) (Brake)                  |
| 783    | 691918  |     | GEAR, Pinion   |
| 783A   | 691269  |     | GEAR, Pinion   |
| 784    | 795095  |     | COVER, Starter Gear                                  |
| 785    | 692352  |     | GASKET-STARTER COVER                                 |
| 789A   | 691372  |     | HARNESS, Wiring<br>-Used Before Code Date 00040700   |
| 789B   | 696547  |     | HARNESS, Wiring                                      |
| 801    | 690782  |     | CAP, Drive   |
| 802    | 695267  |     | CAP, End<br>-Used After Code Date 00040600           |
| 802    | 695975  |     | HOUSING, Starter<br>-Used Before Code Date 00040700  |
| 803    | 695975  |     | HOUSING, Starter<br>-Used Before Code Date 00040700  |
| 803    | 695266  |     | HOUSING, Starter<br>-Used After Code Date 00040600   |
| 851    | 493880S |     | TERMINAL-SPARK PLUG                                  |
| 851A   | 692424  |     | TERMINAL, Spark Plug                                 |
| 853    | 695268  |     | ADAPTER, Wire  |
| 892    | 690646  |     | SWITCH, Key  |
| 910    | 691094  |     | STUD<br>-(Alternator)                                |
| 922    | 691831  |     | SPRING-BRAKE   |
| 922A   | 692135  |     | SPRING, Brake  |
| 923    | 796387  |     | BRAKE<br>-Used After Code Date 08043000              |
| 923A   | 695891  |     | BRAKE  |
| 930    | 691919  |     | GUARD, Rewind<br>-(Round)                            |
| 930A   | 691345  |     | GUARD, Rewind<br>-(Tear Drop)                        |
| 935    | 499421  |     | SWITCH, Interlock<br>-Used Before Code Date 08050100 |
| 937    | 691325  |     | SPLINE, Starter                                      |
| 937A   | 799420  |     | SPLINE, Starter                                      |

# Alternator, Electric Starter, Electrical, Flywheel, Flywheel Brake, Ignition, Rewind Starter

Mfg. No: 12H802-1767-E1

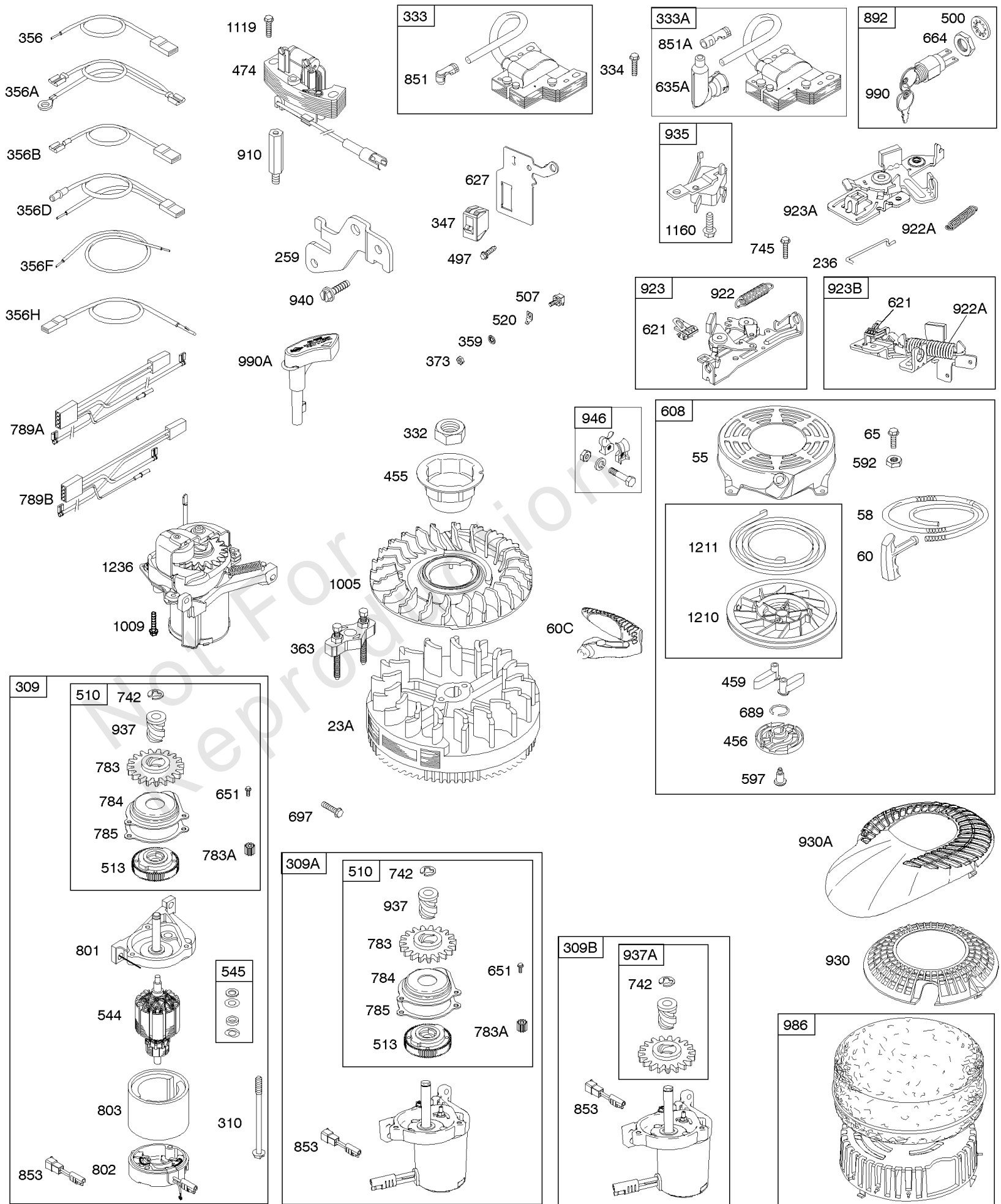

## ***Alternator, Electric Starter, Electrical, Flywheel, Flywheel Brake, Ignition, Rewind Starter***

| <b>REF NO</b> | <b>PART NO</b> | <b>QTY</b> | <b>DESCRIPTION</b>  |
|---------------|----------------|------------|---|
| 940           | 690664         |            | SCREW<br>-(Muffler Guard) (Casing Clamp Bracket)  |
| 946           | 691738         |            | STOP, Rope  |
| 986           | 693514         |            | FILTER, Debris Foam   |
| 990           | 691959         |            | SET, Key  |
| 990A          | 695951         |            | SET, Key<br>-(Touch N Mow)  |
| 1005          | 691346         |            | FAN, Flywheel   |
| 1009          | 696255         |            | SCREW<br>-(USE REFERENCE 697 ONLY)  |
| 1119          | 691648         |            | SCREW<br>-(Muffler Adapter) (Alternator)  |
| 1160          | 690345         |            | SCREW<br>-(Breather Assembly) (Interlock Switch)  |
| 1210          | 498144         |            | PULLEY/SPRING ASSY<br>-(Spring) (Pulley)  |
| 1211          | 498144         |            | PULLEY/SPRING ASSY<br>-(Spring)   |
| 1236          | 695959         |            | STARTER, Mechanical<br>-(Touch N Mow)(Do Not Service Individual Parts, Only As A Whole) |

Not For Reproduction

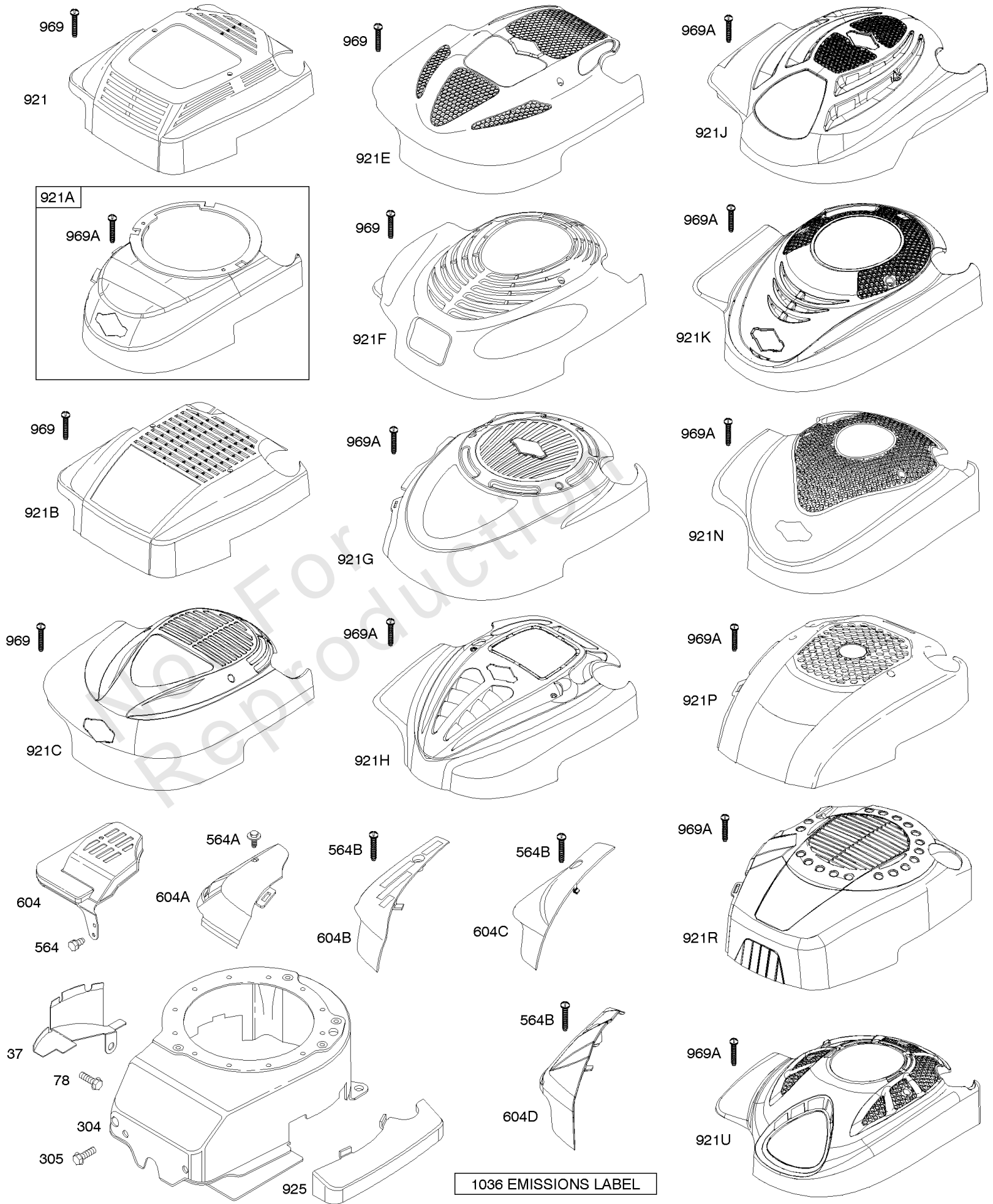

## Blower Housing/Shrouds

| REF NO | PART NO | QTY | DESCRIPTION  |
|--------|---------|-----|--|
| 37     | 694086  |     | GUARD, Flywheel  |
| 78     | 691108  |     | SCREW<br>-(Flywheel Guard)   |
| 304    | 493293  |     | HOUSING, Blower<br>-(Compliance Engines)                                   |
| 305    | 691108  |     | SCREW<br>-(Blower Housing)   |
| 564    | 690664  |     | SCREW<br>-(Control Cover)  |
| 564    | 691132  |     | SCREW<br>-(Control Cover)  |
| 564A   | 691142  |     | SCREW<br>-(Control Cover)  |
| 564B   | 698589  |     | SCREW<br>-(Control Cover)  |
| 604    | 691757  |     | COVER-CONTROL  |
| 604A   | 691344  |     | COVER, Control   |
| 604B   | 790703  |     | COVER, Control   |
| 604C   | 792418  |     | COVER, Control   |
| 604D   | 793770  |     | COVER, Control   |
| 921    | 497233  |     | COVER-BLOWER HSG   |
| 921A   | 695886  |     | COVER-BLOWER HSG   |
| 921U   | 794355  |     | HOUSING, Blower  |
| 921C   | 695889  |     | HOUSING, Blower  |
| 921E   | 696262  |     | HOUSING, Blower  |
| 921F   | 697343  |     | HOUSING, Blower  |
| 921K   | 699984  |     | HOUSING, Blower  |
| 921J   | 790036  |     | HOUSING, Blower  |
| 921H   | 790037  |     | HOUSING, Blower  |
| 921G   | 790701  |     | HOUSING, Blower  |
| 921N   | 792675  |     | HOUSING, Blower  |
| 921P   | 792687  |     | HOUSING, Blower  |
| 921R   | 793771  |     | HOUSING, Blower  |
| 925    | 690595  |     | COVER, Linkage<br>-Used Before Code Date 07072300                          |
| 925    | 795403  |     | COVER-LINKAGE<br>-Used After Code Date 07072200                            |
| 969    | 690700  |     | SCREW<br>-(Blower Housing)   |
| 969A   | 691138  |     | SCREW<br>-(Blower Housing)   |
| 1036   | -----   |     | Label-Emissions<br>-(Available From A Briggs & Stratton Authorized Dealer) |





## ***Cams, Camshaft, Crankshaft, Cylinder, Engine Sump, Kit/Gaskets, Lubrication, Piston***

| <b>REF NO</b> | <b>PART NO</b> | <b>QTY</b> | <b>DESCRIPTION</b>   |
|---------------|----------------|------------|--|
| 1             | 590401         |            | CYLINDER ASSEMBLY<br>-Used After Code Date 11063000                    |
| 1             | 697322         |            | CYLINDER ASSEMBLY<br>-Used Before Code Date 11070100                   |
| 2             | 399269         |            | KIT, Bushing/Seal<br>-(Magneto Side)                                   |
| 3             | 299819S        |            | SEAL, Oil<br>-(Magneto Side)   |
| 4             | 493279         |            | SUMP, Engine   |
| 4A            | 493365         |            | SUMP, Engine<br>-(Auxiliary PTO)                                       |
| 5             | 691160         |            | HEAD, Cylinder<br>-Used Before Code Date 11070100                      |
| 5             | 590411         |            | HEAD, Cylinder<br>-Used After Code Date 11063000                       |
| 7             | 799875         |            | GASKET, Cylinder Head<br>-Used After Code Date 11063000                |
| 7             | 692249         |            | GASKET, Cylinder Head<br>-Used Before Code Date 11070100               |
| 8             | 590395         |            | BREATHER ASSEMBLY<br>-Used After Code Date 11063000                    |
| 8             | 495786         |            | BREATHER ASSEMBLY<br>-Used Before Code Date 11070100                   |
| 9             | 699472         |            | GASKET, Breather<br>-Used After Code Date 11063000                     |
| 9             | 699833         |            | GASKET-BREATHER<br>-Used Before Code Date 11070100                     |
| 10            | 94650          |            | SCREW<br>-(Breather Assembly)  |
| 11            | 691781         |            | TUBE-BREATHER  |
| 12            | 692232         |            | GASKET, Crankcase  |
| 13            | 590422         |            | SCREW<br>-(Cylinder Head)<br>-Used After Code Date 11063000            |
| 13            | 690912         |            | SCREW<br>-(Cylinder Head)<br>-Used Before Code Date 11070100           |
| 15            | 691680         |            | PLUG, Oil Drain<br>-(Square Socket)                                    |
| 15A           | 691093         |            | PLUG, Oil Drain<br>-(Hex Socket)                                       |
| 16            | 694079         |            | CRANKSHAFT   |
| 20            | 399781S        |            | SEAL, Oil<br>-(PTO Side)   |
| 20A           | 691952         |            | SEAL, Oil<br>-(PTO Side) (Auxiliary PTO)                               |
| 22            | 691092         |            | SCREW<br>-(Crankcase Cover/Sump)                                       |
| 24            | 222698S        |            | KEY, Flywheel  |
| 25            | 493386         |            | PISTON ASSEMBLY<br>-(.020 Oversize)<br>-Used Before Code Date 97011300 |
| 25            | 493387         |            | PISTON ASSEMBLY<br>-(.030 Oversize)<br>-Used Before Code Date 97011300 |
| 25            | 590404         |            | PISTON ASSEMBLY<br>-(Standard)<br>-Used After Code Date 11063000       |
| 25            | 590405         |            | PISTON ASSEMBLY<br>-(.020 Oversize)<br>-Used After Code Date 11063000  |



## ***Cams, Camshaft, Crankshaft, Cylinder, Engine Sump, Kit/Gaskets, Lubrication, Piston***

| REF NO | PART NO | QTY | DESCRIPTION  |
|--------|---------|-----|--|
| 25     | 791097  |     | PISTON ASSEMBLY<br>-(Standard)<br>-Used After Code Date 97011200<br>-Used Before Code Date 07090400      |
| 25     | 791326  |     | PISTON ASSEMBLY<br>-(.020 Oversize)<br>-Used After Code Date 97011200<br>-Used Before Code Date 07090400 |
| 25     | 795429  |     | PISTON ASSEMBLY<br>-(Standard)<br>-Used After Code Date 07090300<br>-Used Before Code Date 09041700      |
| 25     | 795430  |     | PISTON ASSEMBLY<br>-(.020 Oversize)<br>-Used After Code Date 07090300<br>-Used Before Code Date 09041700 |
| 25     | 797302  |     | PISTON ASSEMBLY<br>-(Standard)<br>-Used After Code Date 09041600<br>-Used Before Code Date 11070100      |
| 25     | 797303  |     | PISTON ASSEMBLY<br>-(.020 Oversize)<br>-Used After Code Date 09041600<br>-Used Before Code Date 11070100 |
| 25     | 493262  |     | PISTON ASSEMBLY<br>-(Standard)<br>-Used Before Code Date 97011300  |
| 26     | 493389  |     | SET, Ring<br>-(.020 Oversize)<br>-Used Before Code Date 97011300   |
| 26     | 493390  |     | SET, Ring<br>-(.030 Oversize)<br>-Used Before Code Date 97011300   |
| 26     | 499425  |     | SET, Ring<br>-(Standard)<br>-Used After Code Date 97011200<br>-Used Before Code Date 04031500            |
| 26     | 499427  |     | SET, Ring<br>-(.020 Oversize)<br>-Used After Code Date 97011200<br>-Used Before Code Date 04102200       |
| 26     | 590402  |     | SET, Ring<br>-(Standard)<br>-Used After Code Date 11063000   |
| 26     | 590403  |     | SET, Ring<br>-(.020 Oversize)<br>-Used After Code Date 11063000  |
| 26     | 791098  |     | SET, Ring<br>-(Standard)<br>-Used After Code Date 04031400<br>-Used Before Code Date 07090400            |
| 26     | 791324  |     | SET, Ring<br>-(.020 Oversize)<br>-Used After Code Date 04102100<br>-Used Before Code Date 07090400       |
| 26     | 795431  |     | RING SET<br>-(Standard)<br>-Used After Code Date 07090300<br>-Used Before Code Date 09041700             |
| 26     | 795432  |     | SET, Ring<br>-(.020 Oversize)<br>-Used After Code Date 07090300<br>-Used Before Code Date 09041700       |
| 26     | 797304  |     | SET, Ring<br>-(Standard)<br>-Used After Code Date 09041600<br>-Used Before Code Date 11070100            |



## ***Cams, Camshaft, Crankshaft, Cylinder, Engine Sump, Kit/Gaskets, Lubrication, Piston***

| REF NO | PART NO | QTY | DESCRIPTION   |
|--------|---------|-----|---|
| 26     | 797305  |     | SET, Ring<br>-(.020 Oversize)<br>-Used After Code Date 09041600<br>-Used Before Code Date 11070100  |
| 26     | 493261  |     | SET, Ring<br>-(Standard)<br>-Used Before Code Date 97011300   |
| 27     | 691588  |     | LOCK, Piston Pin<br>-Used After Code Date 09041600  |
| 27     | 691866  |     | LOCK-PISTON PIN<br>-Used After Code Date 97011200<br>-Used Before Code Date 09041700                |
| 27     | 691588  |     | LOCK, Piston Pin<br>-Used Before Code Date 97011300   |
| 28     | 298908  |     | PIN, Piston<br>-(.005 Oversize)<br>-Used Before Code Date 97011300                                  |
| 28     | 298909  |     | PIN. Piston<br>-(Standard)<br>-Used Before Code Date 97011300                                       |
| 28     | 298909  |     | PIN. Piston<br>-(Standard)<br>-Used After Code Date 09041600  |
| 28     | 499423  |     | PIN-PISTON/STD<br>-(Standard)<br>-Used After Code Date 97011200<br>-Used Before Code Date 09041700  |
| 29     | 490566  |     | ROD, Connecting<br>-(Standard)<br>-Used Before Code Date 97011300                                   |
| 29     | 499424  |     | ROD, Connecting<br>-(Standard)<br>-Used After Code Date 97011200<br>-Used Before Code Date 09041700 |
| 29     | 797306  |     | ROD, Connecting<br>-(Standard)<br>-Used After Code Date 09041600                                    |
| 32     | 691664  |     | SCREW<br>-(Connecting Rod)  |
| 32A    | 695759  |     | SCREW<br>-(Connecting Rod)<br>-Used After Code Date 00042200  |
| 33     | 590394  |     | VALVE-EXHAUST<br>-Used After Code Date 11063000   |
| 33     | 262651S |     | VALVE, Exhaust<br>-Used Before Code Date 11070100   |
| 34     | 590393  |     | VALVE-INTAKE<br>-Used After Code Date 11063000  |
| 34     | 262652S |     | VALVE, Intake<br>-Used Before Code Date 11070100  |
| 35     | 691270  |     | SPRING, Valve<br>-(Intake)  |
| 36     | 691270  |     | SPRING, Valve<br>-(Exhaust)   |
| 40     | 692194  |     | RETAINER, Valve   |
| 43     | 691997  |     | SLINGER, Governor/Oil   |
| 45     | 690548  |     | TAPPET, Valve   |
| 46     | 492830  |     | CAMSHAFT<br>-Used Before Code Date 96060300   |
| 46     | 691449  |     | CAMSHAFT<br>-Used After Code Date 96060200  |
| 50     | 497465  |     | MANIFOLD, Intake  |



## ***Cams, Camshaft, Crankshaft, Cylinder, Engine Sump, Kit/Gaskets, Lubrication, Piston***

| <b>REF NO</b> | <b>PART NO</b> | <b>QTY</b> | <b>DESCRIPTION</b>   |
|---------------|----------------|------------|--|
| 51            | 272199S        |            | GASKET, Intake   |
| 54            | 691650         |            | SCREW<br>-(Intake Manifold)  |
| 101           | 691623         |            | PIN, Shaft   |
| 146           | 690979         |            | KEY, Woodruff  |
| 163           | 272653S        |            | GASKET, Air Cleaner<br>-(Air Cleaner)  |
| 287           | 690940         |            | SCREW<br>-(Dipstick Tube)  |
| 306           | 690450         |            | SHIELD, Cylinder   |
| 306A          | 790836         |            | SHIELD, Cylinder   |
| 307           | 690345         |            | SCREW<br>-(Cylinder Shield)  |
| 337           | 697451         |            | PLUG, Spark<br>-(EMS)<br>-Used Before Code Date 11070100   |
| 337           | 799876         |            | PLUG, Spark<br>-Used After Code Date 11063000  |
| 337           | 802592S        |            | PLUG, Spark<br>-(Resistor)<br>-Used Before Code Date 11070100  |
| 358           | 590508         |            | GASKET SET, Engine<br>-Used After Code Date 11063000   |
| 358           | 497316         |            | GASKET SET, Engine<br>-Used Before Code Date 11070100  |
| 374           | 691074         |            | WASHER<br>-(Camshaft)  |
| 383           | 89838S         |            | WRENCH-SPARK PLUG  |
| 523           | 499621         |            | DIPSTICK   |
| 524           | 692296         |            | SEAL-DIPSTICK TUBE<br>-(Dipstick Tube)   |
| 525           | 495265         |            | TUBE, Dipstick   |
| 584           | 697734         |            | COVER-BREA PASSAGE   |
| 585           | 691879         |            | GASKET-BREA PASSAGE  |
| 617           | 270344S        |            | SEAL, O-Ring<br>-(Intake Manifold)   |
| 635           | 66538S         |            | BOOT, Spark PLug   |
| 635A          | 793351         |            | SHIELD-SPARK PLUG<br>-(Snap In Style)  |
| 635A          | 792597         |            | BOOT, Spark Plug<br>-(Screw On Style)  |
| 668           | 493823         |            | SPACER<br>-(Includes 2)  |
| 684           | 690345         |            | SCREW<br>-(Breather Passage Cover)   |
| 715           | 691147         |            | SCREW<br>-(Stop Shaft)   |
| 718           | 690959         |            | PIN, Locating  |
| 721           | 690449         |            | STOP, Shaft  |
| 741           | 794388         |            | GEAR, Timing<br>-(Use Without Woodruff Key)<br>-Used After Code Date 07093000<br>-Used Before Code Date 08021800 |
| 741           | 795755         |            | GEAR, Timing<br>-(Plastic)<br>-Used After Code Date 08021700   |
| 741           | 797521         |            | GEAR, Timing<br>-(Metal)<br>-Used After Code Date 08021700   |

**1319 WARNING LABEL**

**REQUIRED** when replacing parts with warning labels affixed.

**1058 OPERATOR'S MANUAL**

**1330 REPAIR MANUAL**

**1019 LABEL KIT**

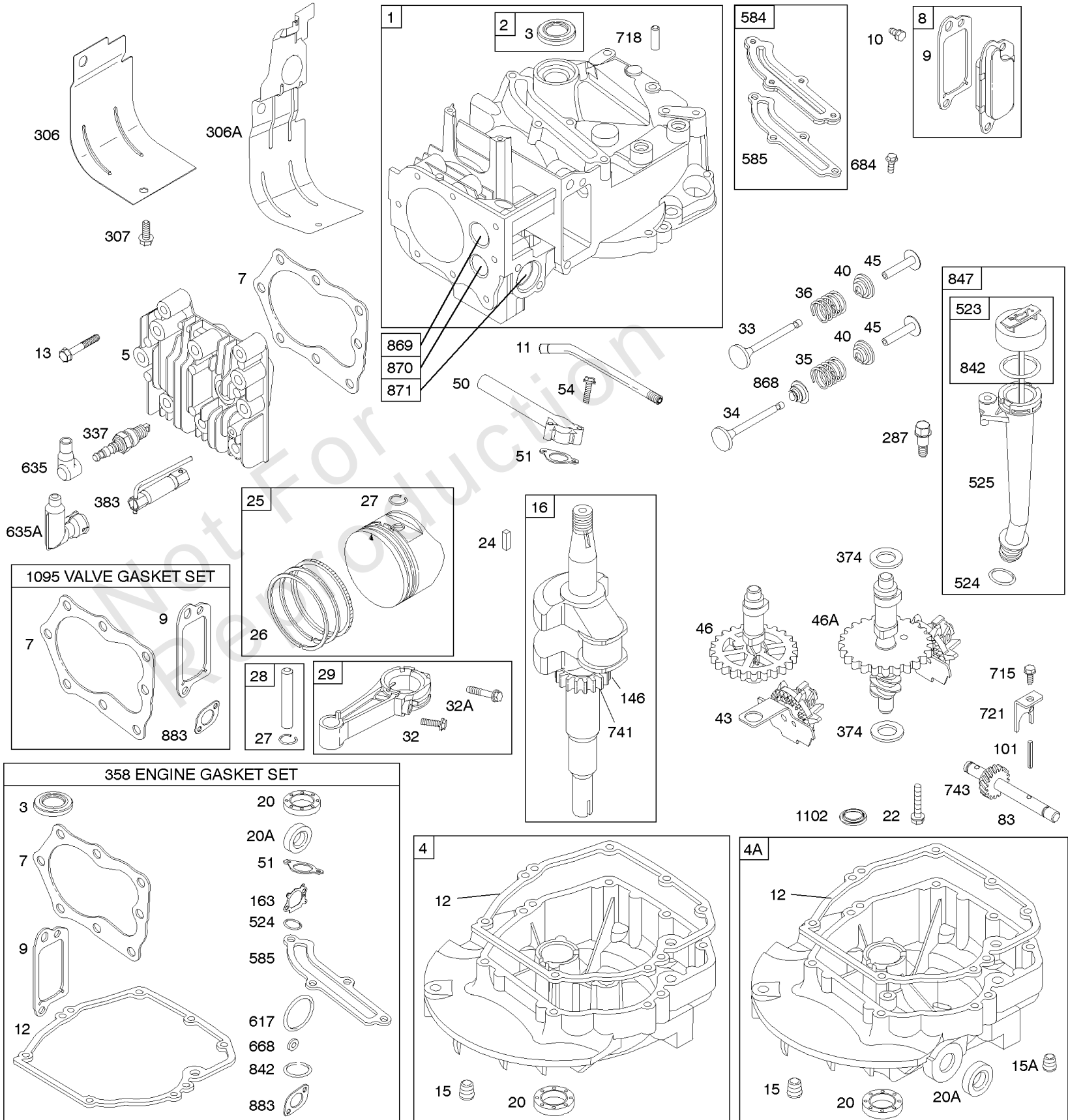



## ***Cams, Camshaft, Crankshaft, Cylinder, Engine Sump, Kit/Gaskets, Lubrication, Piston***

| REF NO | PART NO   | QTY | DESCRIPTION  |
|--------|-----------|-----|--|
| 741    | 691830    |     | GEAR-TIMING<br>-(Uses Woodruff Key)  |
| 741    | 790345    |     | GEAR, Timing<br>-(Use Without Woodruff Key)<br>-Used Before Code Date 07100100 |
| 743    | 691772    |     | GEAR, Drive<br>-(Counterclockwise)   |
| 842    | 691031    |     | SEAL, O-Ring<br>-(Dipstick Tube)   |
| 847    | 692047    |     | DIPSTICK/TUBE ASSY   |
| 868    | 697338    |     | SEAL, Valve<br>-Used Before Code Date 11070100                                 |
| 868    | 590410    |     | SEAL, Valve<br>-Used After Code Date 11063000                                  |
| 869    | 691155    |     | SEAT, Valve<br>-(Intake)   |
| 870    | 690380    |     | SEAT, Valve<br>-(Exhaust)  |
| 871    | 262001    |     | BUSHING-VALVE GUIDE<br>-(Exhaust)<br>-Used Before Code Date 11070100           |
| 871    | 590409    |     | BUSHING, Valve Guide<br>-Used After Code Date 11063000                         |
| 871    | 63709     |     | BUSHING, Valve Guide<br>-(Intake)<br>-Used Before Code Date 11070100           |
| 883    | 691881    |     | GASKET, Exhaust  |
| 1019   | 790231    |     | KIT, Label<br>-(Touch N Mow)   |
| 1019   | 494256    |     | KIT, Label   |
| 1058   | 277039TRI |     | MANUAL, Operator's<br>-Used Before Code Date 11070100                          |
| 1058   | 380567TRI |     | MANUAL, Operator's<br>-Used After Code Date 11063000                           |
| 1095   | 498528    |     | GASKET SET, Valve  |
| 1319   | 794467    |     | LABEL, Warning   |
| 1330   | 270962    |     | REP MAN-1 CYL L-HD   |

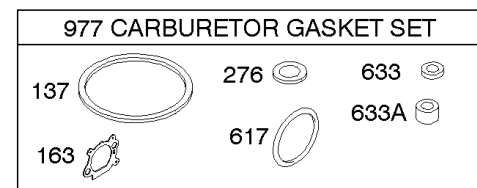
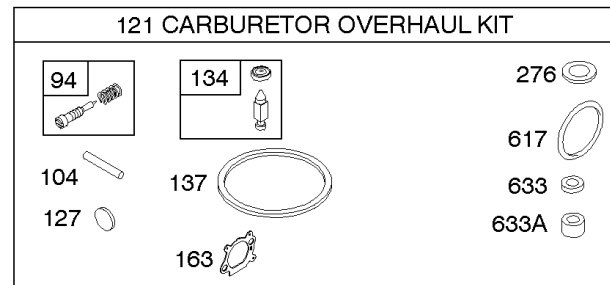
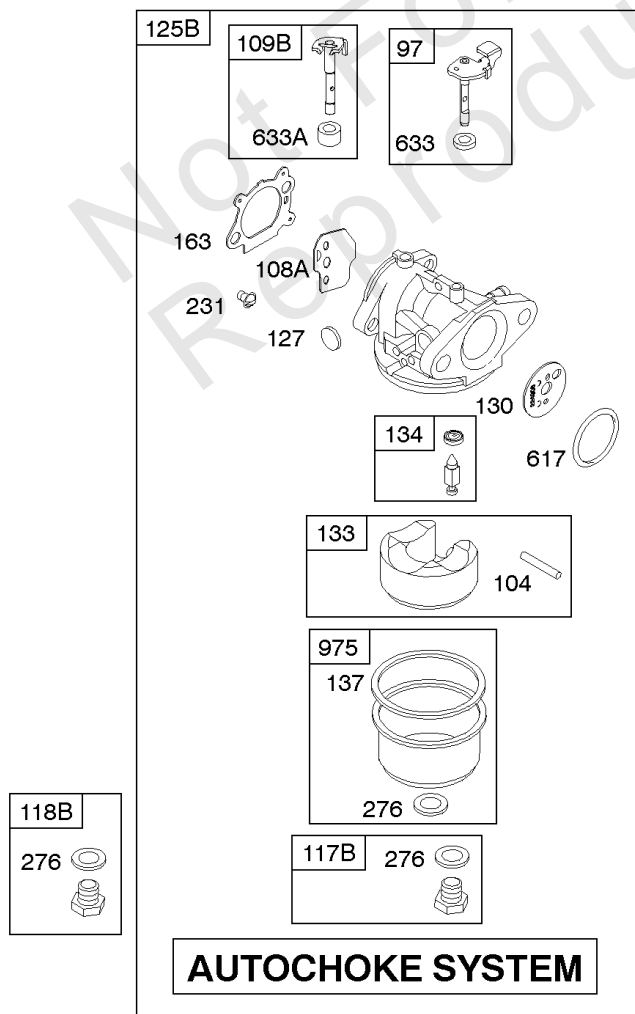
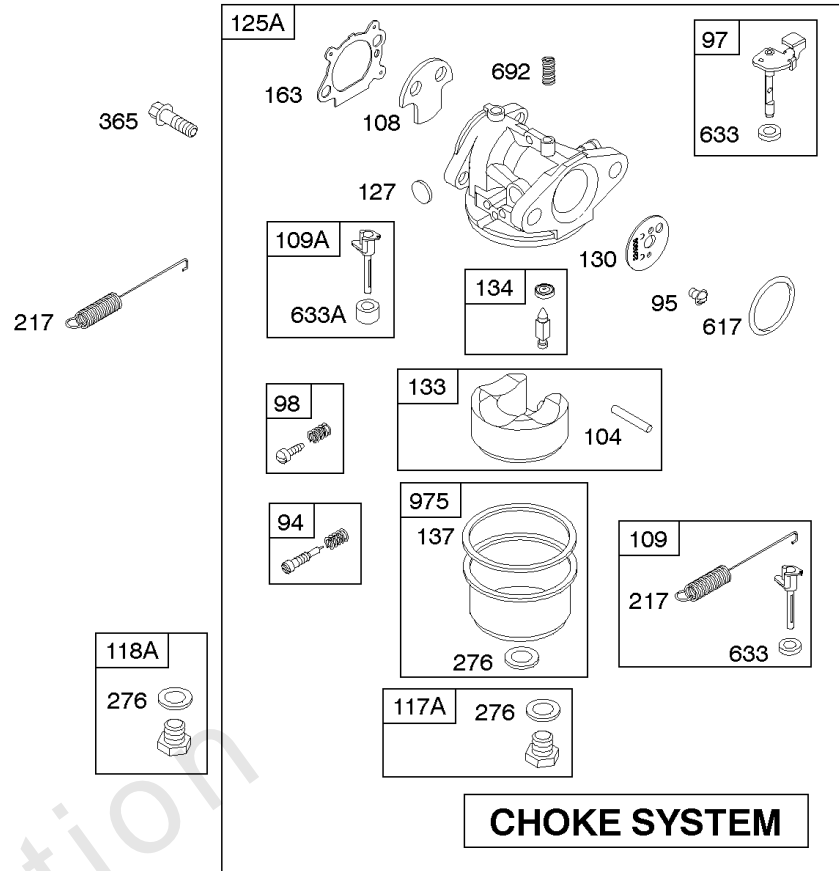
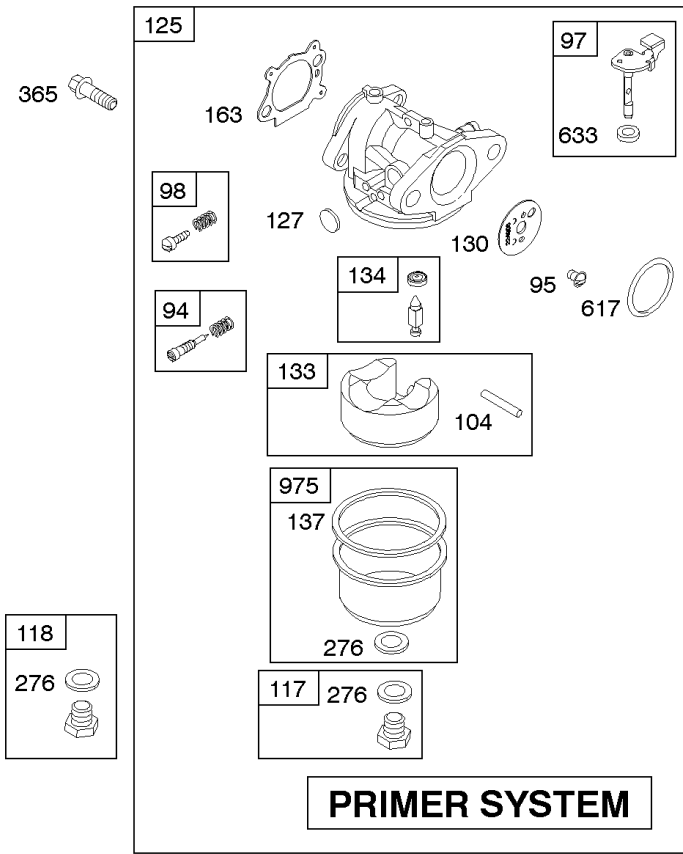

## Carburetor

| REF NO | PART NO | QTY | DESCRIPTION  |
|--------|---------|-----|--|
| 94     | 493765  |     | KIT-IDLE MIXTURE<br>-(Used On Carb. I.d. No. M24)  |
| 95     | 691636  |     | SCREW<br>-(Throttle Valve)   |
| 97     | 493267  |     | SHAFT-THROTTLE<br>-(Metal)   |
| 97     | 696565  |     | SHAFT, Throttle<br>-(Plastic)  |
| 98     | 398185  |     | KIT-IDLE SPEED<br>-(Idle Speed) (Lmt 26, 27, 28, 31)                                     |
| 104    | 691242  |     | PIN, Float Hinge   |
| 108    | 691182  |     | VALVE-CHOKE  |
| 108A   | 795935  |     | VALVE, Choke<br>-Used After Code Date 08031200   |
| 108A   | 790844  |     | VALVE, Choke<br>-Used Before Code Date 08031300  |
| 109    | 494218  |     | KIT, Choke Shaft   |
| 109A   | 498593  |     | SHAFT, Choke   |
| 109B   | 790843  |     | SHAFT, Choke<br>-Used Before Code Date 08031300  |
| 109B   | 795936  |     | SHAFT, Choke<br>-Used After Code Date 08031200   |
| 117    | 494870  |     | JET, Main<br>-(Standard)   |
| 117A   | 498978  |     | JET, Main<br>-(Standard)   |
| 117B   | 697355  |     | JET, Main<br>-(Standard)   |
| 118    | 498975  |     | JET, Main<br>-(High Altitude)  |
| 118A   | 498975S |     | JET, Main<br>-(High Altitude)  |
| 118B   | 692677  |     | JET, Main<br>-(High Altitude)  |
| 121    | 498260  |     | KIT, Carburetor Overhaul   |
| 125    | 498170  |     | CARBURETOR<br>-(Primer)  |
| 125B   | 790845  |     | CARBURETOR<br>-(Autochoke System)  |
| 127    | 694468  |     | PLUG, Welch<br>-(Bowl Vent)  |
| 130    | 696564  |     | VALVE, Throttle<br>-(Used With Plastic Throttle Shaft)<br>-Used After Code Date 01040800 |
| 130    | 691203  |     | VALVE, Throttle  |
| 133    | 398187  |     | FLOAT-CARBURETOR   |
| 134    | 398188  |     | KIT-NEEDLE/SEAT  |
| 137    | 693981  |     | GASKET-FLOAT BOWL<br>-(1/16)   |
| 137    | 796610  |     | GASKET, Float Bowl   |
| 163    | 272653S |     | GASKET, Air Cleaner<br>-(Air Cleaner)  |
| 217    | 690354  |     | SPRING, Choke Return   |
| 231    | 691636  |     | SCREW<br>-(Choke Valve)  |
| 276    | 271716  |     | WASHER-SEALING   |
| 365    | 691688  |     | SCREW<br>-(Carburetor/Throttle Body)   |

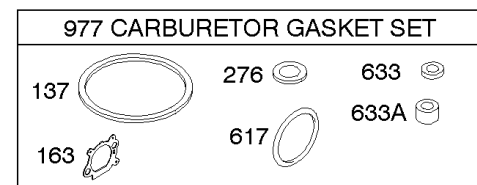
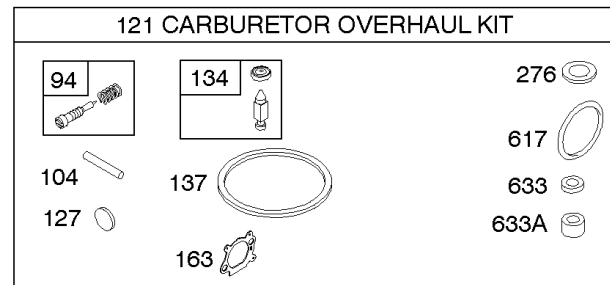
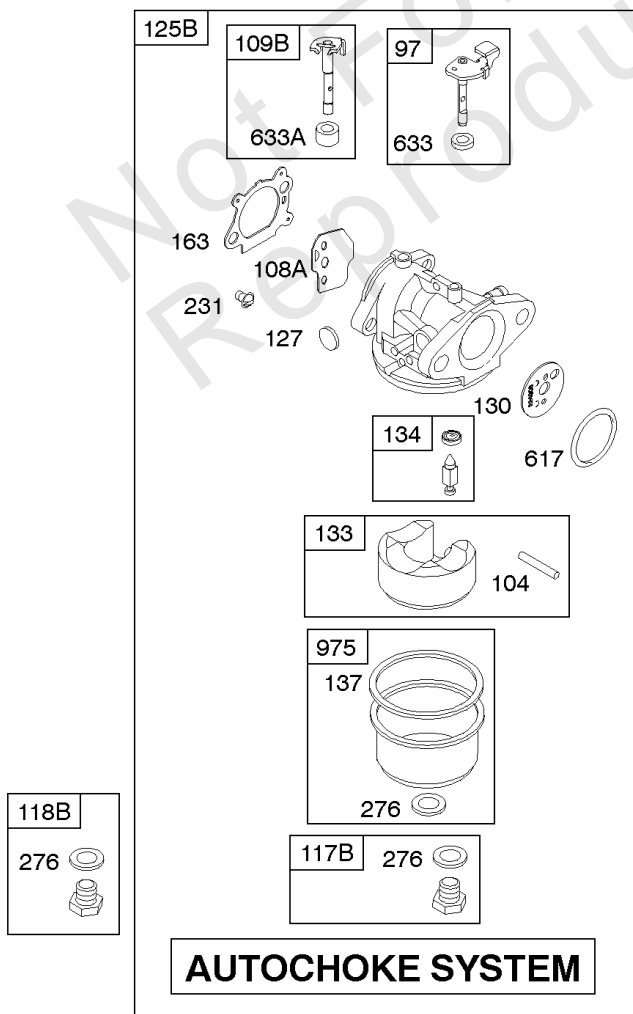
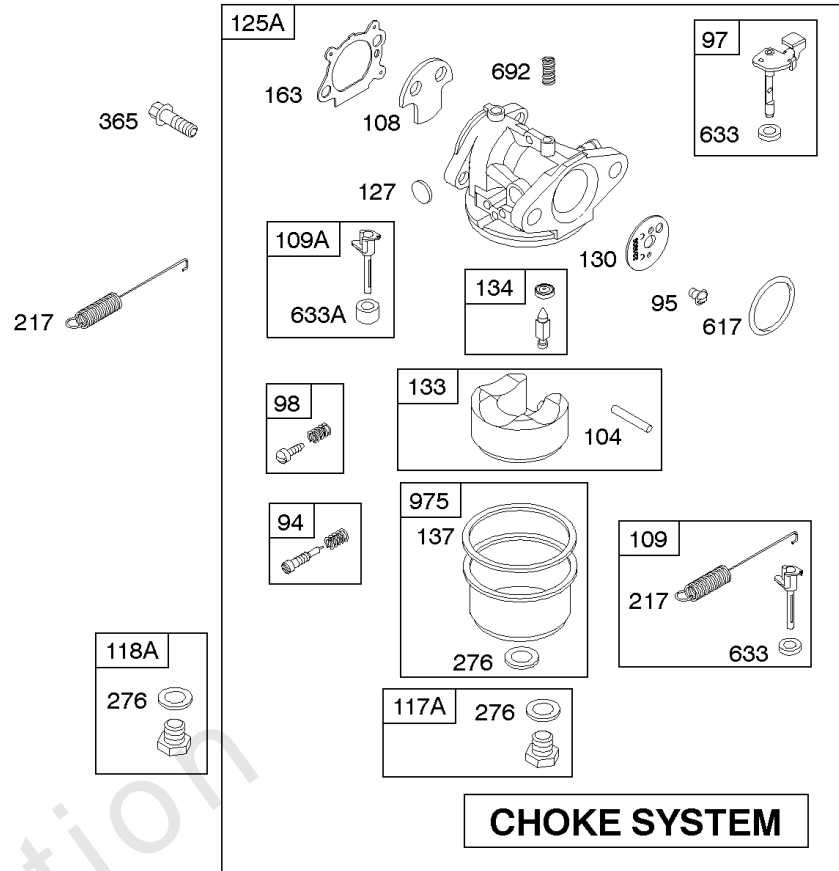
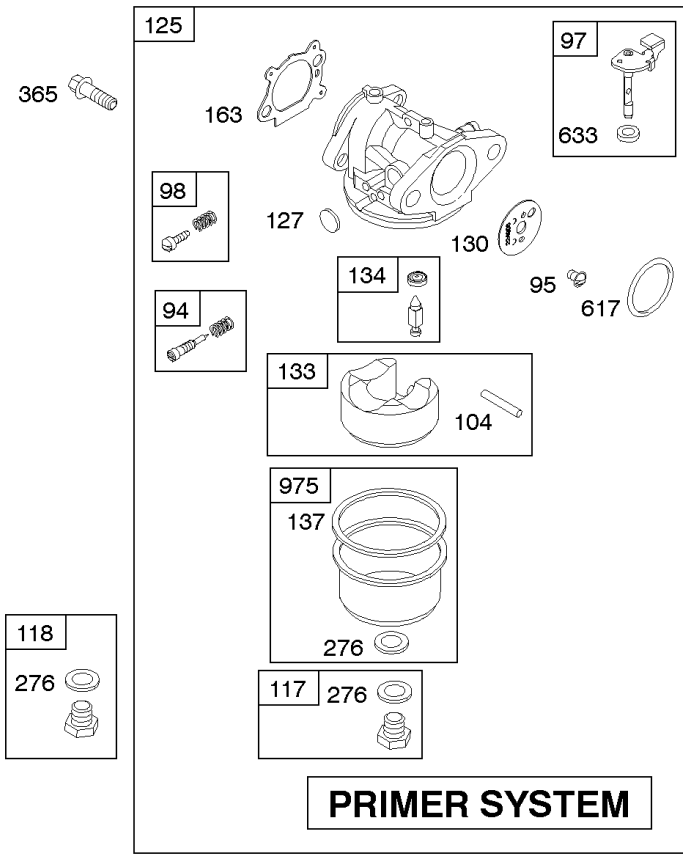

## Carburetor

| REF NO | PART NO | QTY | DESCRIPTION                               |
|--------|---------|-----|---|
| 617    | 270344S |     | SEAL, O-Ring<br>-(Intake Manifold)        |
| 633    | 691321  |     | SEAL-CHOKE/THR SHAFT<br>-(Throttle Shaft) |
| 633A   | 693867  |     | SEAL, Choke/Throttle Shaft                |
| 692    | 690572  |     | SPRING, Detent                            |
| 975    | 493640  |     | BOWL, Float                               |
| 977    | 498261  |     | SET, Carburetor Gasket                    |

Not For Reproduction

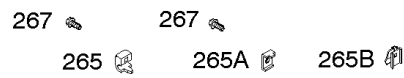
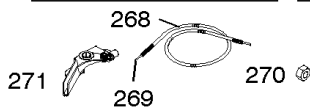
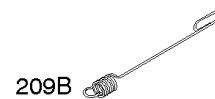
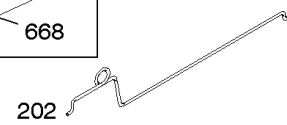
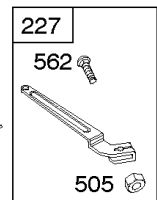
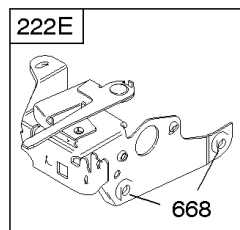
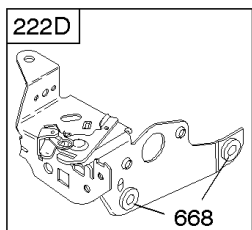
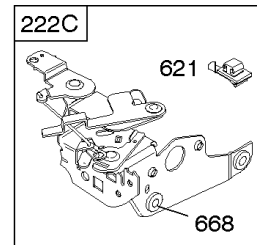
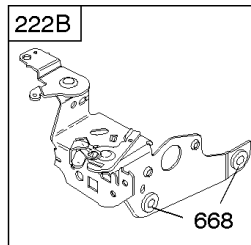
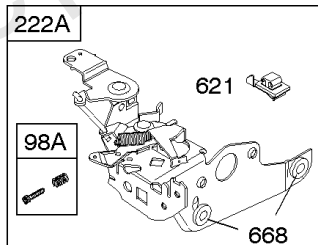
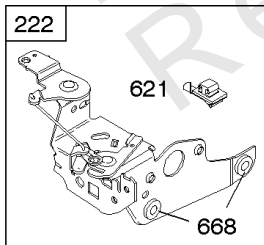
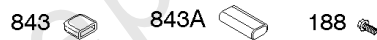
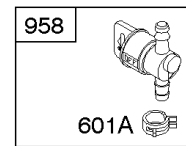
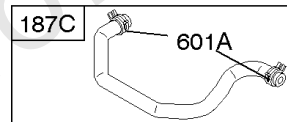
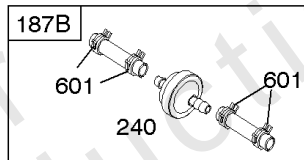
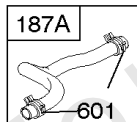
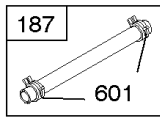
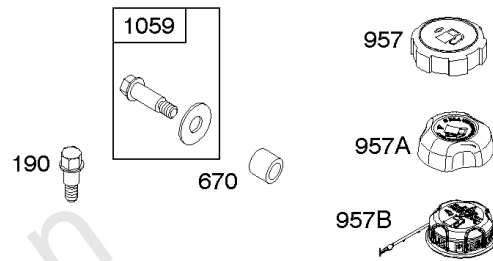
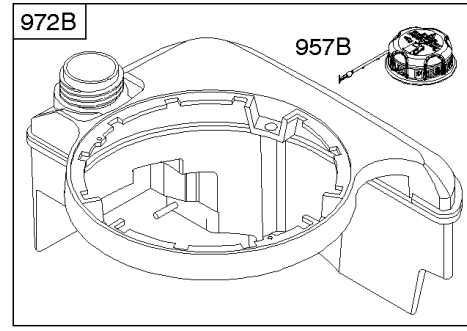
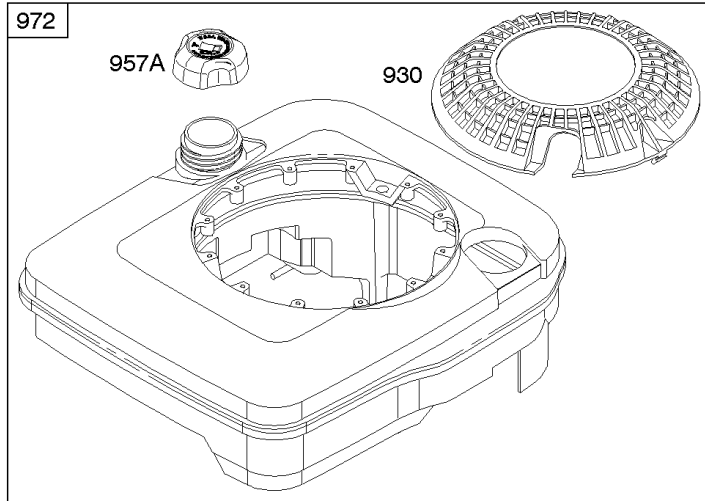

## Controls, Fuel Supply, Governor Spring

| REF NO | PART NO | QTY | DESCRIPTION                                       |
|--------|---------|-----|---|
| 98A    | 493280  |     | KIT-IDLE SPEED<br>-(Idle Speed)                   |
| 187    | 791766  |     | LINE, Fuel<br>-(Cut To Required Length)           |
| 187A   | 791873  |     | LINE-FUEL<br>-(Molded)                            |
| 187C   | 791875  |     | LINE, Fuel<br>-(Molded)                           |
| 187B   | 791891  |     | LINE-FUEL<br>-(Includes Filter)                   |
| 188    | 690877  |     | SCREW<br>-(Control Bracket)                       |
| 190    | 690940  |     | SCREW<br>-(Fuel Tank)                             |
| 202    | 691829  |     | LINK, Mechanical Governor                         |
| 209B   | 691292  |     | SPRING, Governor                                  |
| 222D   | 791128  |     | BRACKET, Control                                  |
| 227    | 690783  |     | LEVER-GOV CONTROL                                 |
| 240    | 298090S |     | FILTER, Fuel                                      |
| 265    | 690798  |     | CLAMP, Casing                                     |
| 265A   | 691024  |     | CLAMP, Casing                                     |
| 265B   | 692179  |     | CLAMP-CASING                                      |
| 267    | 691044  |     | SCREW<br>-(Casing Clamp)                          |
| 268    | 691025  |     | CASING, Control Wire<br>-(Cut To Required Length) |
| 269    | 691026  |     | WIRE, Control<br>-(Cut To Required Length)        |
| 270    | 691027  |     | NUT<br>-(Control Wire Casing)                     |
| 271    | 691028  |     | LEVER, Control                                    |
| 404    | 690272  |     | WASHER<br>-(Governor Crank)                       |
| 505    | 691251  |     | NUT<br>-(Governor Control Lever)                  |
| 562    | 92613   |     | BOLT<br>-(Governor Lever)                         |
| 601    | 791850  |     | CLAMP, Hose                                       |
| 601A   | 691038  |     | CLAMP, Hose                                       |
| 615    | 690340  |     | RETAINER, Governor Shaft                          |
| 616    | 698801  |     | CRANK-GOVERNOR                                    |
| 621    | 692310  |     | SWITCH, Stop                                      |
| 668    | 493823  |     | SPACER<br>-(Includes 2)                           |
| 670    | 692294  |     | SPACER, Fuel Tank                                 |
| 843    | 691884  |     | SLEEVE, Lever<br>-(Speed Control)                 |
| 843A   | 691895  |     | SLEEVE, Lever<br>-(Choke)                         |
| 930    | 691919  |     | GUARD, Rewind<br>-(Round)                         |
| 957    | 397974S |     | CAP, Fuel Tank                                    |
| 957A   | 692046  |     | CAP, Fuel Tank                                    |
| 957B   | 699985  |     | CAP, Fuel Tank                                    |
| 958    | 698183  |     | VALVE, Fuel Shut Off                              |
| 972    | 699392  |     | TANK, FUEL  |

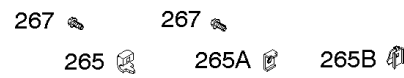
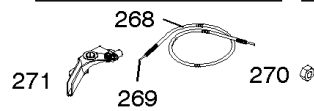
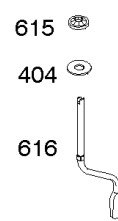
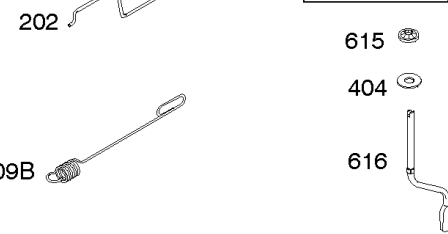
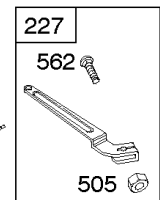
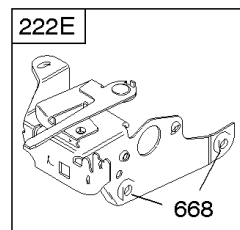
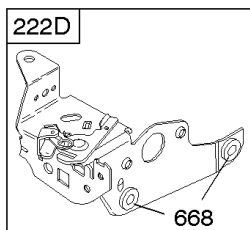
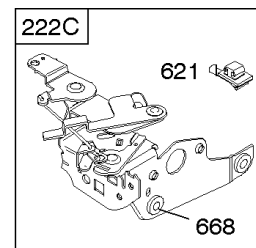
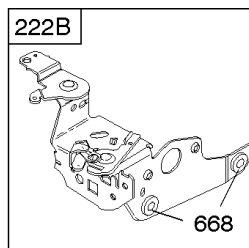
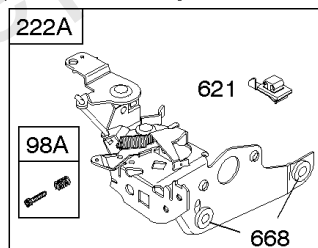
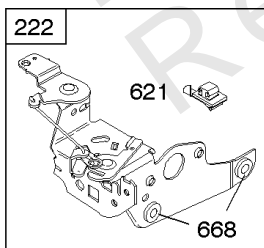
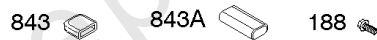
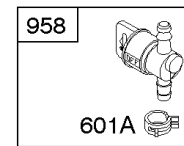
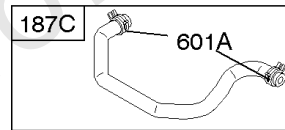
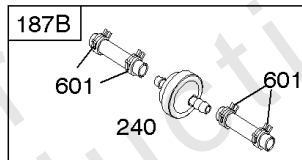
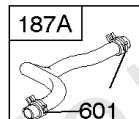
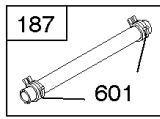
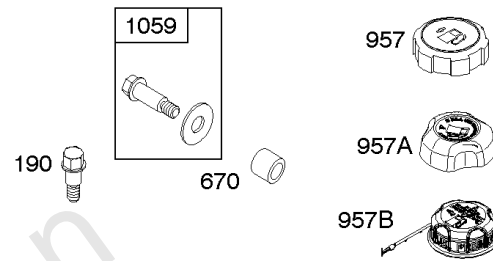
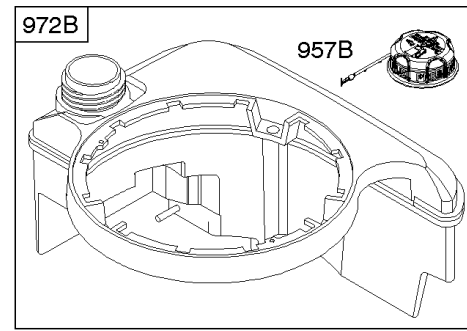
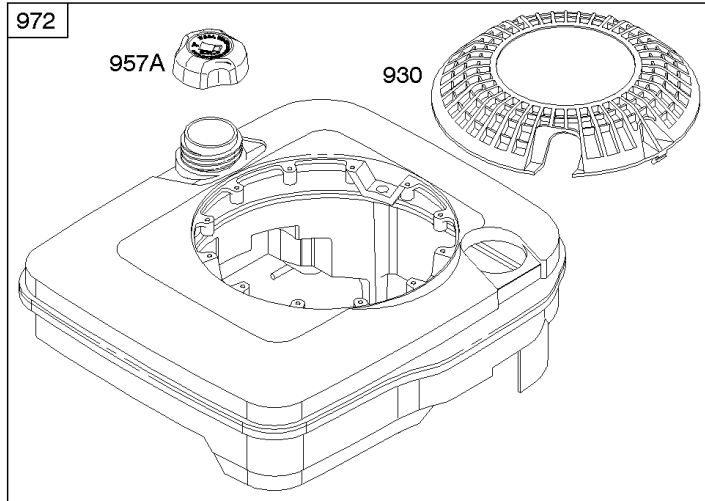



## ***Controls, Fuel Supply, Governor Spring***

---

| <b>REF NO</b> | <b>PART NO</b> | <b>QTY</b> | <b>DESCRIPTION</b>                  |
|---------------|----------------|------------|-------------------------------------|
| 972B          | 699374         |            | TANK, Fuel                          |
| 1059          | 692311         |            | KIT, Screw/Washer                   |
| 1059          | 696293         |            | KIT, Screw/Washer<br>-(Touch N Mow) |

---

Not For Reproduction

## Replacement Engine - US & Canada

| REF NO | PART NO    | QTY | DESCRIPTION  |
|--------|------------|-----|--|
|        | 126T021701 | 1   | Replacement Engine   |
|        | 694810     | 1   | Replacement Short Block  |
|        | -----      |     | Top No-Load Speed: 3000<br>-Trim: ALL  |
|        | -----      |     | Service Note: Transfer Muffler and/or Spark Arrester Assembly from the original engine if suitable for additional service or add new parts as required |
|        | -----      |     | Service Note: Replacement engine listed is not available in the State of California. Repair with individual parts.                                     |

Not For Reproduction

