

# 10-28 LUBRICATION

Engine Accessories  
Lubrication

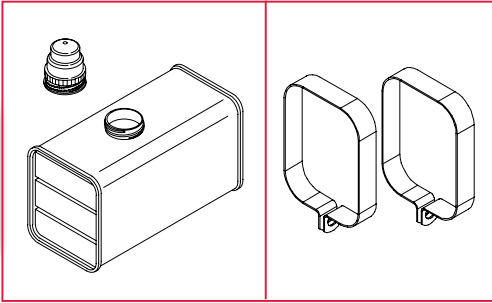

## Fuel Tanks for Remote Mounting

Fuel Tank Capacity	Fuel Tank and Cap	Mounting Straps (2 Required)
4 qt. (3.8 L)	<b>Part # 290816</b> (metal) or <b>Part # 691993</b> (plastic)	<b>Part # 291367</b>
6 qt. (5.7 L) (H 6.2", W 5.45", L 10.75")	<b>Part # 291488</b> (metal)	<b>Part # 691937</b>
8 qt. (7.5 L) (H 6.2", W 5.45", L 14.37")	<b>Part # 292415</b> (metal)	<b>Part # 691937</b>

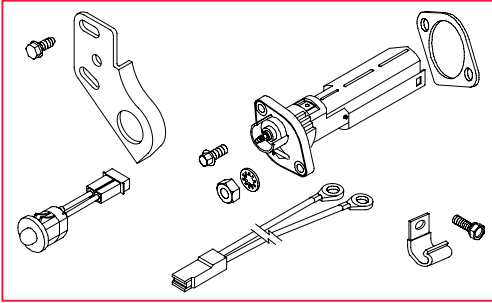

## Oil Gard Kits

Oil Gard automatically stops the engine if the oil level is too low. It can be added to I/C® and Vanguard™ engines equipped to receive it.

### Models (horizontal crankshaft)

For 5 Gross HP† thru 11 Gross HP equipped to receive Oil Gard, **Part # 398182**  
For 9 Gross HP† Vanguard™, **Part # 492697**

NOTE: Magnetic oil drain plug recommended with Oil Gard

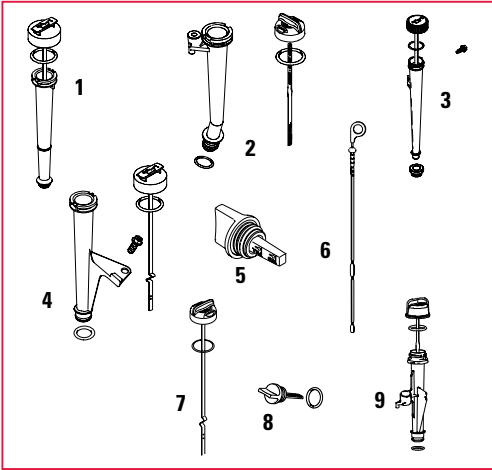

## Dipsticks

Be sure dipsticks fit on your application

1. Models 110400, 121400, 123400, **Part # 693617**
2. Models 110600, 111600, 120600, 121600, 122600, 126600, **Part # 692047**
3. Models 310700, 311700, **Part # 496415**
4. Models 405600, 406700, 445700, **Part # 499602**
5. Models 120400, 204400, 205400, **Part # 697689**
6. Models 303400, 350400, 381400 (after 98053100), **Part # 693175**
7. Models 310000, **Part # 699908**
8. Models 50032, **Part # 715588**
9. Models 121Q00, 121S00, **Part # 796501**

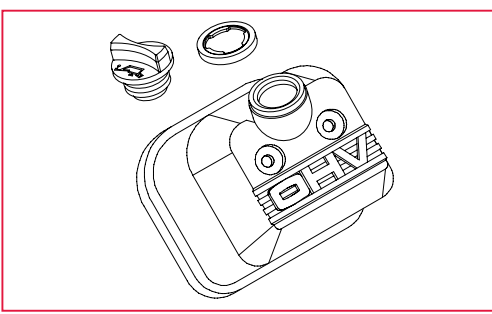

## Valve Cover Oil Fill

Valve cover oil fills are available for Vanguard™ V-Twin Models 30, 35, and 38 horizontal crankshaft engines.

Valve cover oil fill, if engine is not equipped with fuel pump, **Part # 843749**

Valve cover oil fill, if engine is equipped with fuel pump, **Part # 690910**

Oil fill cap (before assembly, cut dipstick from cap, if equipped), **Part # 809500**



† All power levels are stated gross torque per SAE J1940 as rated by Briggs & Stratton.  
‡ All power levels are stated gross HP per SAE J1940 as rated by Briggs & Stratton.

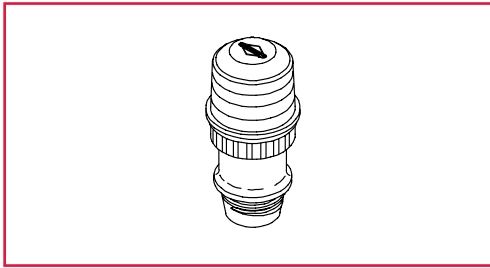

### Oil Minders

Gives visual indication of "safe" oil level with a touch of a finger.  
 Most 3 Gross HP thru 12 Gross HP<sup>†</sup> vertical crankshaft engines, **Part # 692939**  
 Most 2 Gross HP thru 8 Gross HP<sup>‡</sup> horizontal crankshaft engines, **Part # 298858**  
 Most 9 Gross HP thru 16 Gross HP<sup>‡</sup> cast iron cylinder horizontal crankshaft engines, **Part # 298860**

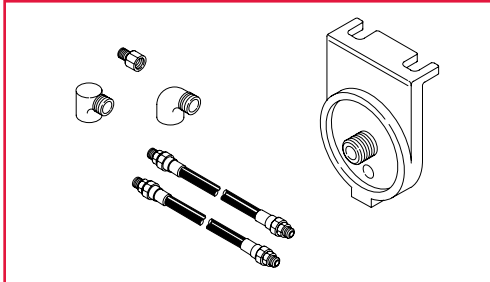

### Remote Mounting Oil Filter Kits

For Vanguard™ V-Twin engines and Opposed Twin II™ engines equipped with full pressure lubrication.

Length of Hoses: 18" (48 cm), **Part # 492061**

30" (76 cm), Filter not included, **Part # 492062**

To order parts separately: (2) 18" hoses, **Part # 494724**

(2) 30" hoses, **Part # 494725**

Oil filter kit without hoses, **Part # 495244**

NOTE: Opposed Twin II™ requires adapter kit 492675. Vanguard™ requires adapter kit 492687

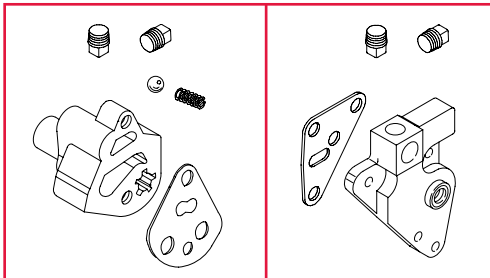

### Oil Filter Adapter Kits

Opposed Twin II™ engines (includes spacer), **Part # 492675**

Vanguard™ V-Twin engines, **Part # 492687**

NOTE: Adapter has provision to receive oil pressure switches.

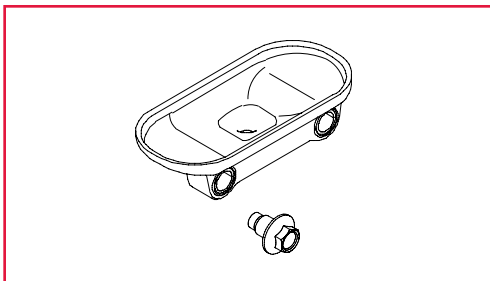

### Oil Drip Tray

Models 540000 and 61000, **Part # 809334**

Bolts for drip tray, **Part # 807435**

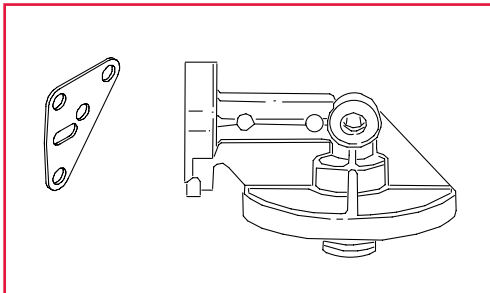

### Oil Filter Adapter

Oil filter adapter kit re-locates oil filter on Vanguard™ V-Twin horizontal crankshaft engines when muffler is mounted on oil filter side of engine (see page 10-20). Use mounting hardware from original adapter, **Part # 808033**

NOTE: Adapter has provision to receive oil pressure switches.

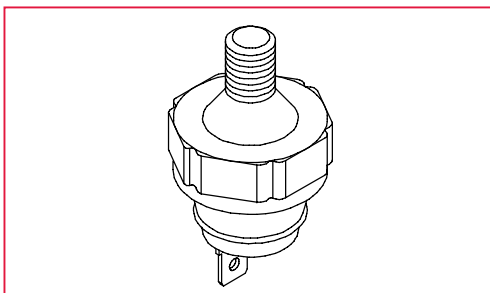

### Oil Pressure Switch

Oil pressure switches activate a warning light if oil pressure drops to an unsafe level. Available for V-Twin engines and Opposed Twin II™ cylinder engines equipped with full pressure lubrication and oil filter. This is a normally closed switch.

2 PSI, **Part # 690233**

3-5 PSI, **Part # 491657S**

9-13 PSI, **Part # 694115**

All Switches are 1/8 x 27 NPTF.

† All power levels are stated gross torque per SAE J1940 as rated by Briggs & Stratton.  
 ‡ All power levels are stated gross HP per SAE J1940 as rated by Briggs & Stratton.

# 10-30 LUBRICATION

Engine  
Accessories  
Lubrication

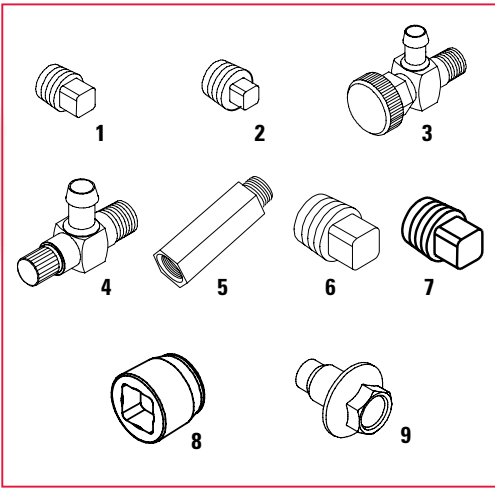

## Oil Drain Plugs & Fittings

A magnetic oil drain plug is recommended with Oil Gard. 1/2 turn oil drain fitting makes oil changes easier.

Models (horizontal crankshaft)

1. 5 Gross HP<sup>†</sup>, 1/4 x 18 NPTF, **Part # 691663**
2. 7 Gross HP<sup>‡</sup> thru 11 Gross HP, 3/8 x 18 NPTF (magnetic), **Part # 690289**
3. 5 Gross HP<sup>‡</sup> and under, 1/4 x 18 NPTF (1/4" I.D. Dia.), **Part # 492030**
4. Above 5 Gross HP<sup>‡</sup>, 3/8 x 18 NPTF (1/2" I.D. Dia.), **Part # 492031**
5. Vanguard™ single cylinder oil drain extension, **Part # 715715**
6. Vanguard™ Twin, 3/8 x 18 NPTF, **Part # 690946**
7. Model 12 horizontal, 1/4 x 18 NPTF, **Part # 691686**
8. Intek™ V-Twin, 1/2" 3/8 x 18 NPTF recessed square, **Part # 691680**
9. 2 cylinder liquid-cooled Vanguard™ 540000 & 610000, M14 x 1.5 thread, **Part # 807392**



<sup>†</sup> All power levels are stated gross torque per SAE J1940 as rated by Briggs & Stratton.  
<sup>‡</sup> All power levels are stated gross HP per SAE J1940 as rated by Briggs & Stratton.